

# Knauf Aquapanel Interior

## Installation procedure – large commercial projects

For larger commercial applications, such as changing rooms and leisure centres, Knauf Aquapanel Interior commercial systems use an innovative glued joint system to allow 600mm stud centres with no loss in performance. Please contact Knauf Technical Services for further information.

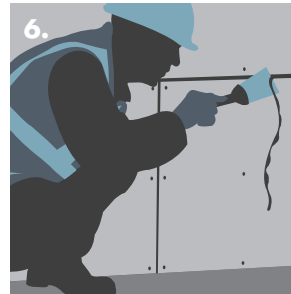
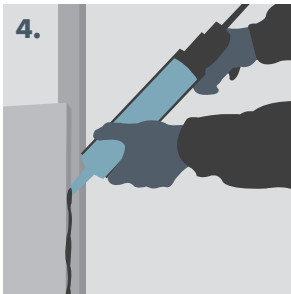

### Framework 1

We recommend the use of lightweight metal Knauf Acoustic 'C' Studs. Using metal studs ensures accuracy, and they will not move or twist due to shrinkage or water ingress. In either case, set studs at maximum 600mm centres.

### Align the board 2

Knauf Aquapanel Interior Cement Boards are laid horizontally. Start at one end and align the first board along the studs. Secure the board with Knauf Aquapanel Maxi Screws (SN) at maximum 250mm centres, ensuring that the screws are at least 15mm from the board edge. Do not overdrive the screws.

### Clean the adjacent board edges 3

In order to ensure that maximum adhesion is achieved when jointing, the adjacent edges of the fixed board and the next board in sequence must be cleaned. Simply clean the edges with a wet brush to remove traces of dust – the edges do not need to be soaked.

### Applying adhesive 4

Using a suitable gun, apply a continuous bead of Knauf Interior Aquapanel Joint Adhesive to the adjacent edge of the fixed board(s). The bead should be of sufficient size to fill the joint fully when the next board is offered up.

Important note: Knauf Aquapanel Interior Joint Adhesive must be applied before the next board is fixed, not after.

### Place the next board 5

Align the next board and push it firmly into the bed of adhesive. The gap between boards should be less than 1mm. Secure the board with Knauf Aquapanel Maxi Screws (SN).

### Continue the process

Continue to clean the adjacent edges, apply Knauf Aquapanel Interior Joint Adhesive and place and secure the next board.

### Leave adhesive to dry

In order to achieve a strong bond and to form a complete joint, the Knauf Aquapanel Interior Joint Adhesive needs to be left to cure and expand before the excess can be scraped off.

### Scrape off the excess adhesive 6

Scrape off the excess Knauf Aquapanel Interior Joint Adhesive the next day using a flexible steel scraper.

# Knauf Aquapanel Interior

## Installation procedure – domestic/small commercial projects

Knauf Aquapanel Interior systems can be designed to meet the requirements of Approved Document E and can be installed with either treated timber or metal studs. Knauf Aquapanel Interior is jointed with tile adhesive and Knauf Aquapanel Interior Joint Tape prior to tiling. Below are the installation instructions for domestic/small commercial projects using the Knauf Aquapanel Interior system.

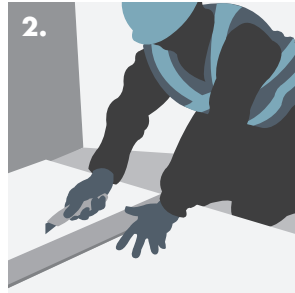
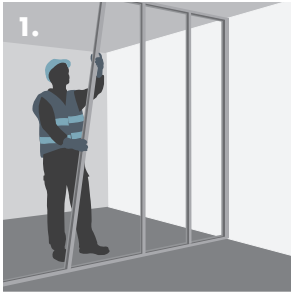

### Framework 1

For the best results, we recommend the use of lightweight metal Knauf Acoustic 'C' Studs. Using metal studs ensures accuracy, and they will not move or twist due to shrinkage or water ingress. In any case, set studs at maximum 450mm centres.

### Cutting Knauf Aquapanel Interior Cement Board 2,3

Knauf Aquapanel Interior is easily and accurately cut using a coarse bladed saw, or by simply scoring and snapping. Score one side with a sharp knife, cutting through the mesh. Snap the board along the score, then cut through mesh on other side. Smooth any rough areas caused by scoring with a rasp.

### Fixing Knauf Aquapanel Interior 4

Knauf Aquapanel Interior should be screwed to the framework at maximum 250mm centres, with screws 15mm from the board edge. Use 25mm Knauf Aquapanel Maxi Screws (SN) if fixing into metal studs, and 40mm Knauf Aquapanel Interior Screws if fixing into timber studs. Ensure all joints between boards are staggered and leave a 3mm gap.

Generate specifications at [www.knauf.co.uk](http://www.knauf.co.uk)

### Reinforcing joints 5

All joints should be filled with flexible tile adhesive, and Knauf Aquapanel Interior Joint Tape embedded into the wet adhesive.

### Tiling 6

Always use a quality polymer modified based flexible tile adhesive, following the manufacturer's instructions. Tile on the smooth side of the board.

### Sealing interfaces

Permanently flexible sealant should be used at corners, at wall to floor connections, around penetrations, and at interfaces with baths and shower trays, in combination with sealing tape in wet areas.